

QPD4-698-4000-50-4

4-Way, 0.698~4GHz

Features:

- * Small Size
- * Low Insertion Loss

Applications:

- * Amplifiers
- * Mixers
- * Antennas
- * Laboratory Test

Electrical

Frequency:	0.698~4GHz
Insertion Loss:	1.5dB max.
Input VSWR:	1.3 max.
Output VSWR:	1.2 max.
Isolation:	20dB min.
Amplitude Balance:	0.3dB max.
Phase Balance:	±4°
Impedance:	50Ω
Average Power:	50W max. 3W max. as combiner

Mechanical

Size*1:	178*128*30mm 7.008*5.039*1.181in
Weight:	1000g
Connectors:	4.3-10 Female
Mounting:	6-Φ5.5mm through-hole

[1] Exclude connectors.

Environmental

Operation Temperature:	-35~+75°C
------------------------	-----------

Outline Drawings

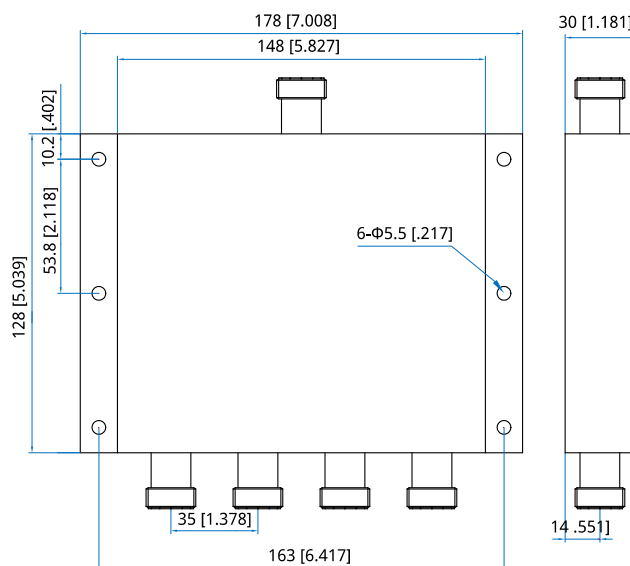

Unit: mm [in]

Tolerance: ±0.5mm [±0.02in]

How To Order

QPD4-698-4000-50-4

Customization is available upon request.